



QUALCOMM[®]



rethink 
robotics.

CRUISE



 **hiDOF**

McCormick
Northwestern Engineering
**Master of Science
in Robotics**

 **Robotnik**



 **Shadow**
Robot Company

 **SwRI**

 **TOYOTA**

 **YASKAWA**
MOTOMAN ROBOTICS

BLUE  RIVER
TECHNOLOGY

Organizing committee



Tully Foote



Ryan Gariepy



Brian Gerkey



Jarvis Schultz

Program committee

- Michael Ferguson
- Sarah Osentoski
- Mike Purvis
- Chad Rockey
- Ioan Sucan
- Alex Teichman

Today

Time	Presenter	Title
0900		Opening remarks
0915	Adolfo Rodríguez Tsouroukdissian	ros_control: An overview
1000	Alexander Bubeck	Development of dual arm mobile manipulation systems for small part assembly tasks
1045		Coffee break
1115	Steve Peters	Comparison of rigid body dynamic simulators for robotic simulation in Gazebo
1140	Dirk Thomas, William Woodall, Esteve Fernandez	Next-generation ROS: Building on DDS
1205	Lorenz Halt (presented by Alex Bubeck)	EuRoC - The European Robotic Challenges
1230		Lunch

1400	Austin Hendrix	The current state of ROS and Ubuntu on ARM
1425	Mike Purvis	Serious roserial
1450	Mike Ferguson	Continuous integration for ROS in commercial environments
1515	Dirk Thomas, William Woodall, Esteve Fernandez	ROS 2.0: Developer preview
1600		Coffee break
1630	Sascha Schade	How ROS works together with the mining industry in i2Mine project
1655	Kat Scott	Practical experiences using ROS to build a three axis pick and place assembly robot
1720	Everyone	Lightning talks
1755	Everyone	Birds of a feather
1830	Everyone	Reception
2000		Fin

<http://roscon.ros.org/2014/program/>

Tomorrow

Time	Presenter	Title
0900	Allison Thackston	ROS in space
0945	William Curran	The ROS ecosystem: Impact, insights, and improvements
1010	Enrico Hoffman	Control and perception architecture for the tele-operation of the humanoid robot COMAN
1035		Coffee Break
1105	David V. Lu!!	Navigation illumination: Shedding light on the ROS navstack
1150	Andrew Symington	Cognitive Robotics Architecture for Tightly-coupled Experiments and Simulation (CRATES)
1215	Chris Lewis	ROS-Industrial calibration
1240		Lunch

1410	Everyone	Lightning talks
1445	Everyone	Birds of a feather
1525		Coffee break
1555	Ren Sang Nah	ROS support from MATLAB
1640	Daniel Lazewatsky	Rapid prototyping with rosh
1705		Closing remarks
1715		Fin

<http://roscon.ros.org/2014/program/>

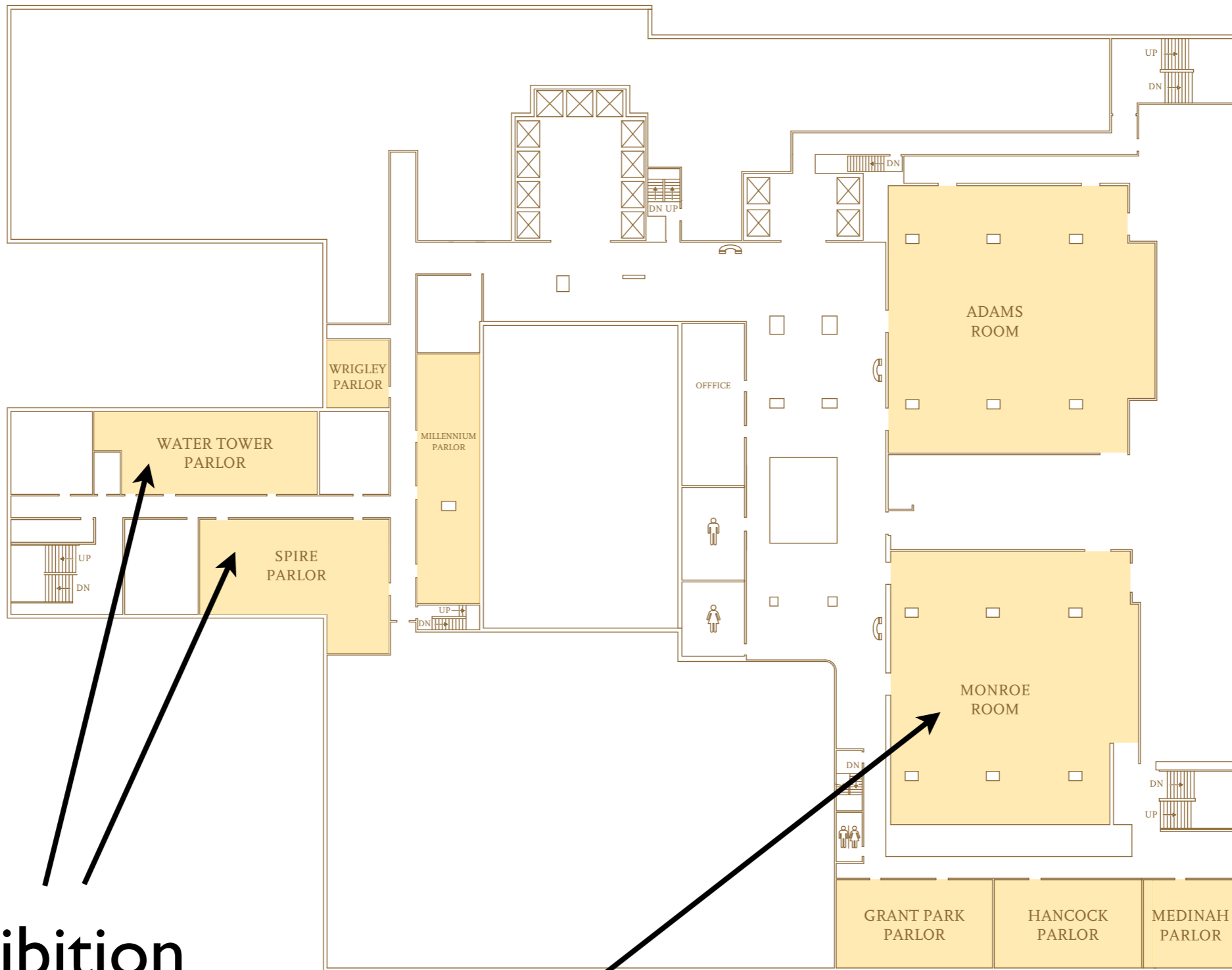

**Exhibition
rooms**

We are here



Session 1: 5.20pm today
Session 2: 2.10pm tomorrow

Sign up by giving your name
and/or slides to:

Signup deadline: end of the previous break / lunch



Session 1: 5.55pm today
Session 2: 2.45pm tomorrow

Sign up by proposing and/or
voting on a topic, by the
registration desk

Signup deadline: end of the previous break / lunch



Attendees by affiliation type

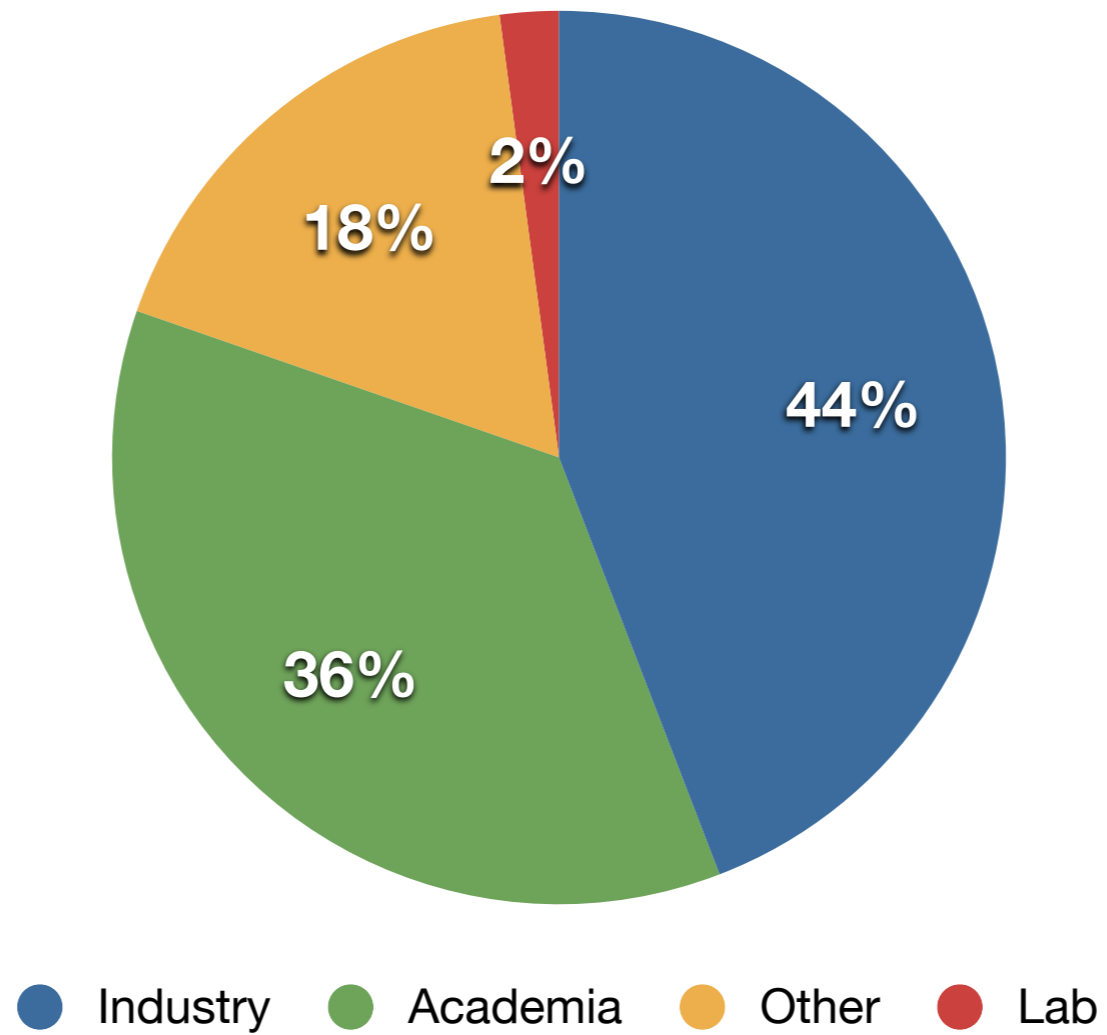

Total: 195

What's new since last time?



Metrics

(from July 2014, not counting mirrors)

 ROS.org

Documentation

Page views: 976,031
+48% over last year

 ROS ANSWERS

Page views: 291,849
+32%

<http://packages.ros.org>

Unique IPs downloading: 49,153
+343%
Total downloads: 3,570,374
+123%

<http://wiki.ros.org/Metrics>

Who's hiring in academia?

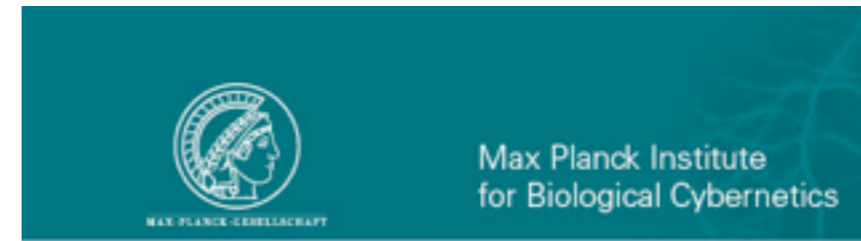

NORTHWESTERN
UNIVERSITY



Stanford
Artificial Intelligence Laboratory



Carnegie Mellon
THE ROBOTICS INSTITUTE



University of
Zurich^{UZH}



Who's hiring in industry?



HRL LABORATORIES, LLC



Children's National

SHEIKH ZAYED INSTITUTE for Pediatric Surgical Innovation

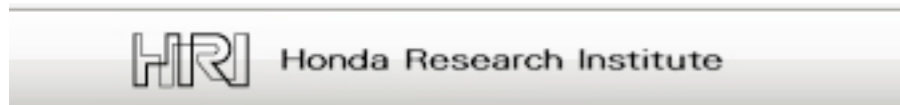
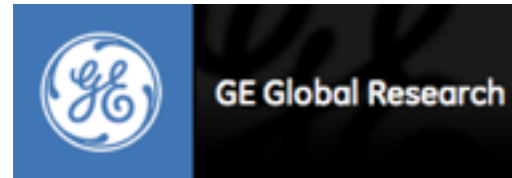

All trademarks and registered trademarks are the property of their respective owners

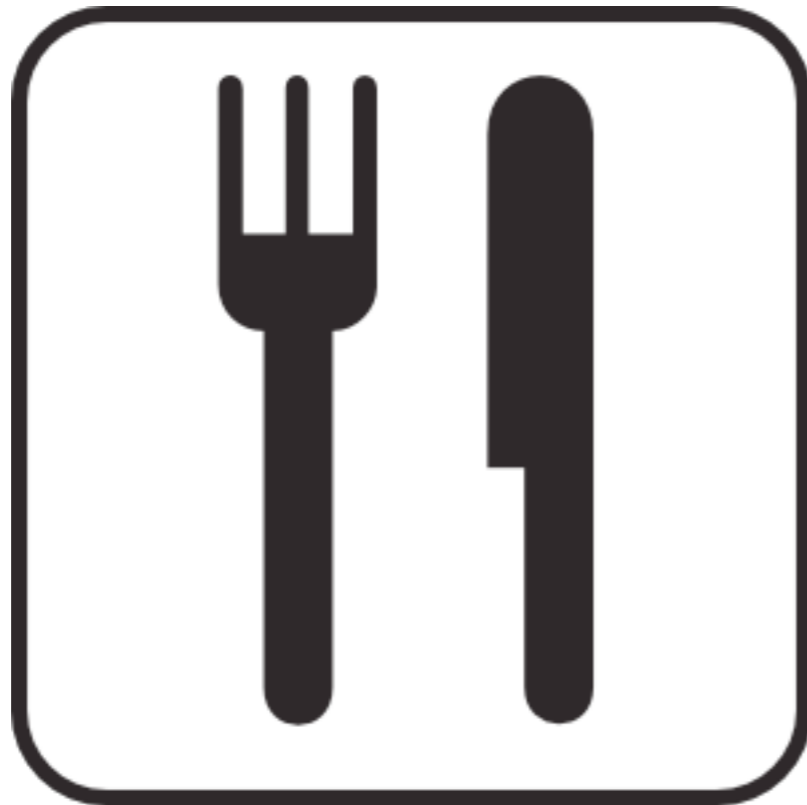

AM & PM breaks
DIY lunches



Reception
6.30pm today



SSID: PH_Meeting_Room
Username: ROSCON2014
Password: ROSCON2014

QUALCOMM[®]



rethink 
robotics.

CRUISE



 **hiDOF**

McCormick
Northwestern Engineering
**Master of Science
in Robotics**

 **Robotnik**



 **Shadow**
Robot Company

 **SwRI**

 **TOYOTA**

 **YASKAWA**
MOTOMAN ROBOTICS

BLUE  RIVER
TECHNOLOGY